

Drop over cover for an Ev Eliminator i Top. Unit size 429mm x 609mm x 768mm high. Make covers Internal dimensions 450mm x 630mm x 775mm high. Black Nypad cover, open at base to fit over speaker. Two cut outs, one on each side, for access to unit handles.

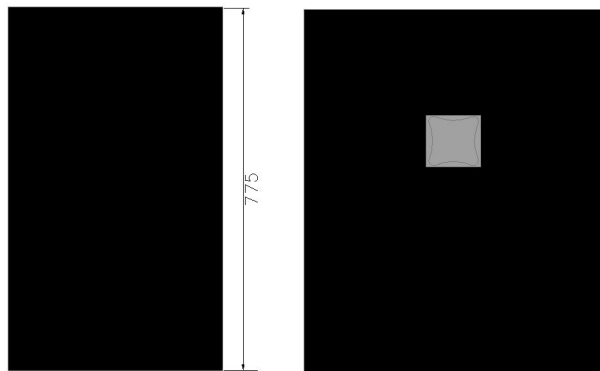

SCALE: 1:16

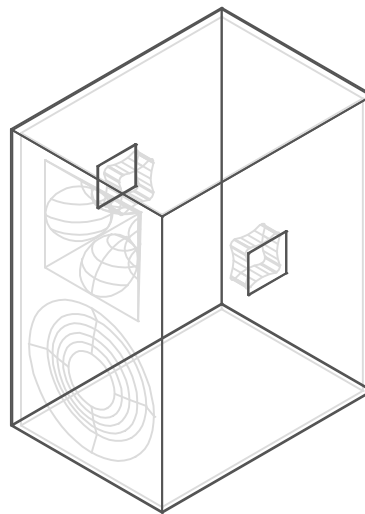
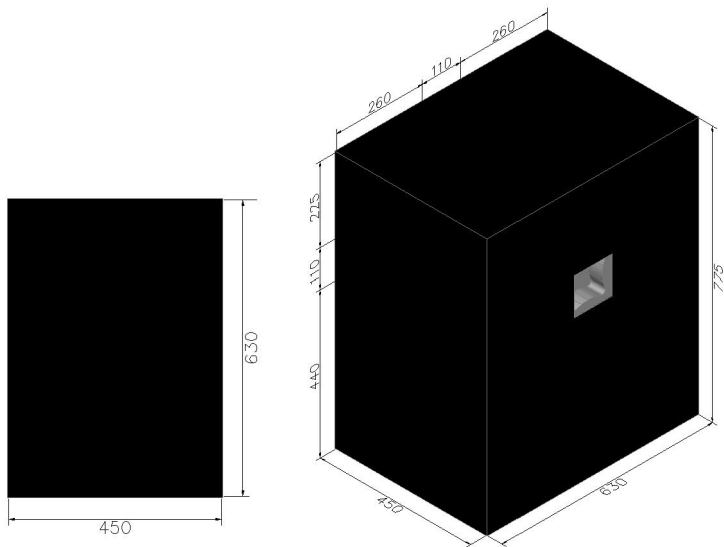
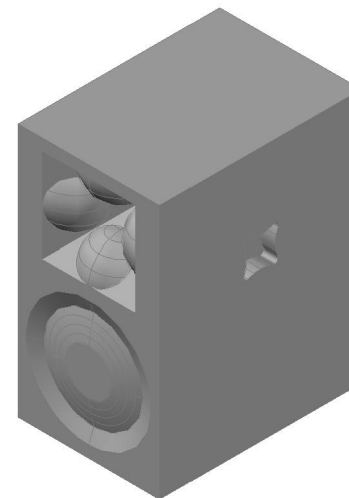

DATE:	26/11/09
REVISION:	1
DRAWN BY:	A.M.M.
TITLE:	Drop over cover for an Ev Eliminator i Top